

Z:\\_REP Projects\2021\21040 Canyon Co. Landfill\CAD Sheets\21040 Demo Paving02 Addendum.dwg plotted by: Josh on Mon, December 19, 2022 at 04:13 PM

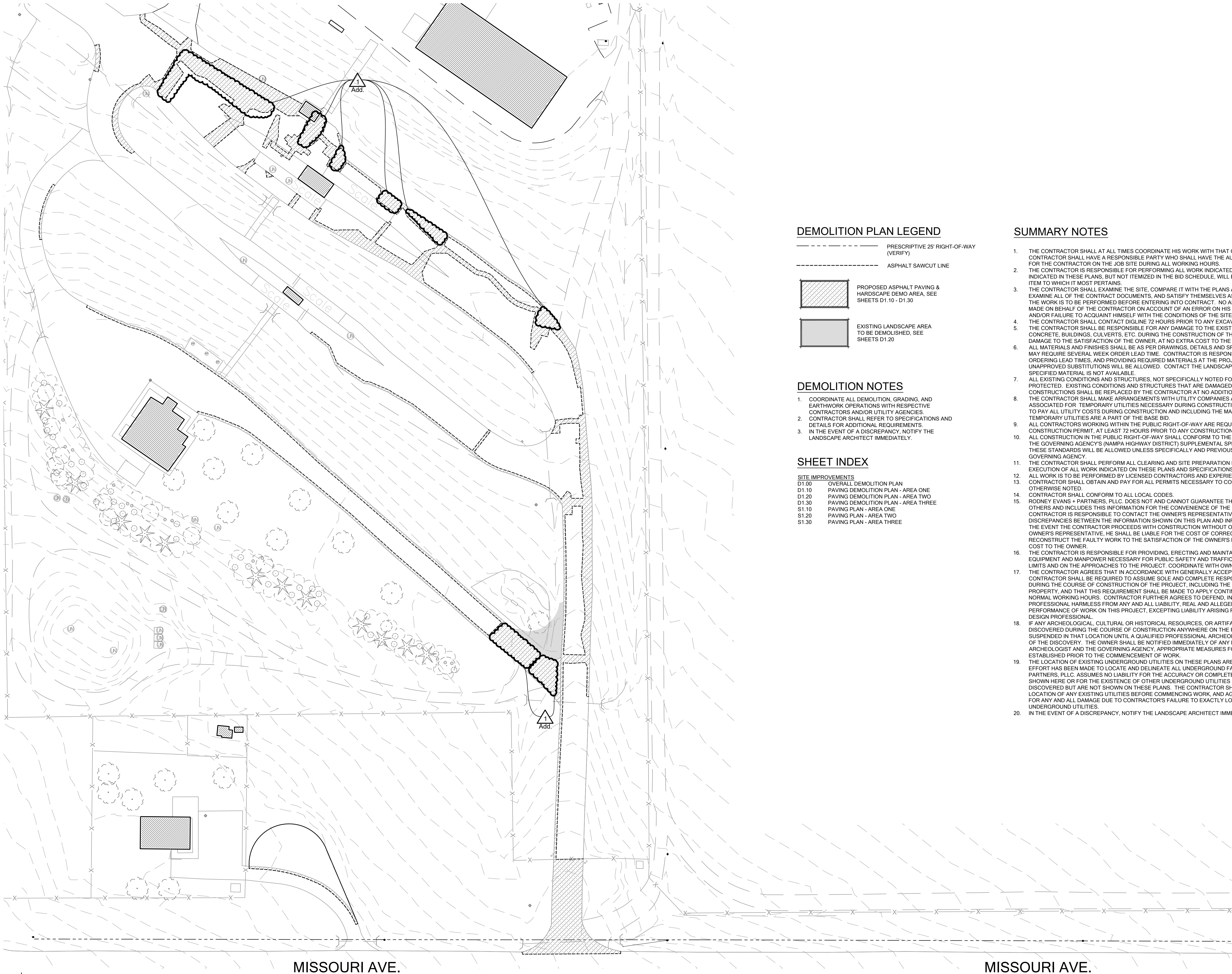

# OVERALL PAVING DEMOLITION PLAN

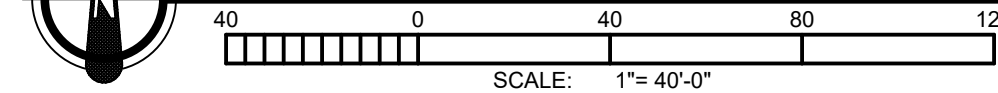

## DEMOLITION PLAN LEGEND

- PREScriptive 25' RIGHT-OF-WAY (VERIFY)
- ASPHALT SAWCUT LINE
- PROPOSED ASPHALT PAVING & HARDSCAPE DEMO AREA, SEE SHEETS D1.10 - D1.30
- EXISTING LANDSCAPE AREA TO BE DEMOLISHED, SEE SHEETS D1.20

## DEMOLITION NOTES

- COORDINATE ALL DEMOLITION, GRADING, AND EARTHWORK OPERATIONS WITH RESPECTIVE CONTRACTORS AND/OR UTILITY AGENCIES.
- CONTRACTOR SHALL REFER TO SPECIFICATIONS AND DETAILS FOR ADDITIONAL REQUIREMENTS.
- IN THE EVENT OF A DISCREPANCY, NOTIFY THE LANDSCAPE ARCHITECT IMMEDIATELY.

## SHEET INDEX

- | SITE IMPROVEMENTS |                                     |
|-------------------|-------------------------------------|
| D1.00             | OVERALL DEMOLITION PLAN             |
| D1.10             | PAVING DEMOLITION PLAN - AREA ONE   |
| D1.20             | PAVING DEMOLITION PLAN - AREA TWO   |
| D1.30             | PAVING DEMOLITION PLAN - AREA THREE |
| S1.10             | PAVING PLAN - AREA ONE              |
| S1.20             | PAVING PLAN - AREA TWO              |
| S1.30             | PAVING PLAN - AREA THREE            |

## SUMMARY NOTES

- THE CONTRACTOR SHALL AT ALL TIMES COORDINATE HIS WORK WITH THAT OF OTHERS ON THE SITE. THE CONTRACTOR SHALL HAVE A RESPONSIBLE PARTY WHO SHALL HAVE THE AUTHORITY TO REPRESENT AND ACT FOR THE CONTRACTOR ON THE JOB SITE DURING ALL WORKING HOURS.
- THE CONTRACTOR IS RESPONSIBLE FOR PERFORMING ALL WORK INDICATED IN THESE PLANS. ANY ITEM INDICATED IN THESE PLANS, BUT NOT ITEMIZED IN THE BID SCHEDULE, WILL BE INCLUDED UNDER A BID SCHEDULE ITEM TO WHICH IT MOST PERTAINS.
- THE CONTRACTOR SHALL EXAMINE THE SITE, COMPARE IT WITH THE PLANS AND SPECIFICATIONS, CAREFULLY EXAMINE ALL OF THE CONTRACT DOCUMENTS, AND SATISFY THEMSELVES AS TO THE CONDITIONS UNDER WHICH THE WORK IS TO BE PERFORMED BEFORE ENTERING INTO CONTRACT. NO ALLOWANCE SHALL SUBSEQUENTLY BE MADE ON BEHALF OF THE CONTRACTOR ON ACCOUNT OF AN ERROR ON HIS PART AND/OR HIS NEGLIGENCE AND/OR FAILURE TO ACQUAINT HIMSELF WITH THE CONDITIONS OF THE SITE.
- THE CONTRACTOR SHALL CONTACT DOWLINE 72 HOURS PRIOR TO ANY EXCAVATION. 1-800-342-1585.
- THE CONTRACTOR SHALL BE RESPONSIBLE FOR ANY DAMAGE TO THE EXISTING ASPHALT RIGHTS OF WAY, CONCRETE, BUILDINGS, CULVERTS, ETC. DURING THE CONSTRUCTION OF THIS PROJECT, AND SHALL REPAIR SUCH DAMAGE TO THE SATISFACTION OF THE OWNER, AT NO EXTRA COST TO THE OWNER.
- ALL MATERIALS AND FINISHES SHALL BE AS PER DRAWINGS, DETAILS AND SPECIFICATIONS. SOME MATERIALS MAY REQUIRE SEVERAL WEEK ORDER LEAD TIME. CONTRACTOR IS RESPONSIBLE FOR DETERMINING ANY AND ALL ORDERING LEAD TIMES, AND PROVIDING REQUIRED MATERIALS AT THE PROJECT SITE IN A TIMELY MANNER. NO UNAPPROVED SUBSTITUTIONS WILL BE ALLOWED. CONTACT THE LANDSCAPE ARCHITECT IMMEDIATELY IF A SPECIFIED MATERIAL IS NOT AVAILABLE.
- ALL EXISTING CONDITIONS AND STRUCTURES, NOT SPECIFICALLY NOTED FOR REMOVAL, SHALL BE RETAINED AND PROTECTED. EXISTING CONDITIONS AND STRUCTURES THAT ARE DAMAGED DURING THE COURSE OF CONSTRUCTIONS SHALL BE REPLACED BY THE CONTRACTOR AT NO ADDITIONAL COST TO THE OWNER.
- THE CONTRACTOR SHALL MAKE ARRANGEMENTS WITH UTILITY COMPANIES AND IS RESPONSIBLE FOR ALL COSTS ASSOCIATED FOR TEMPORARY UTILITIES NECESSARY DURING CONSTRUCTION. CONTRACTOR IS RESPONSIBLE TO PAY ALL UTILITY COSTS DURING CONSTRUCTION AND INCLUDING THE MAINTENANCE PERIOD. COSTS FOR TEMPORARY UTILITIES ARE A PART OF THE BASE BID.
- ALL CONTRACTORS WORKING WITHIN THE PUBLIC RIGHT-OF-WAY ARE REQUIRED TO SECURE A RIGHT-OF-WAY CONSTRUCTION PERMIT, AT LEAST 72 HOURS PRIOR TO ANY CONSTRUCTION.
- ALL CONSTRUCTION IN THE PUBLIC RIGHT-OF-WAY SHALL CONFORM TO THE LATEST EDITION OF THE ISPPWC AND THE GOVERNING AGENCY'S (NAMP HIGHWAY DISTRICT) SUPPLEMENTAL SPECIFICATIONS. NO EXCEPTIONS TO THESE STANDARDS WILL BE ALLOWED UNLESS SPECIFICALLY AND PREVIOUSLY APPROVED IN WRITING BY THE GOVERNING AGENCY.
- THE CONTRACTOR SHALL PERFORM ALL CLEARING AND SITE PREPARATION NECESSARY FOR THE PROPER EXECUTION OF ALL WORK INDICATED ON THESE PLANS AND SPECIFICATIONS.
- ALL WORK IS TO BE PERFORMED BY LICENSED CONTRACTORS AND EXPERIENCED WORKERS.
- CONTRACTOR SHALL OBTAIN AND PAY FOR ALL PERMITS NECESSARY TO COMPLETE THE WORK, UNLESS OTHERWISE NOTED.
- CONTRACTOR SHALL CONFORM TO ALL LOCAL CODES.
- RODNEY EVANS + PARTNERS, PLLC, DOES NOT AND CANNOT GUARANTEE THE ACCURACY OF WORK DONE BY OTHERS AND INCLUDES THIS INFORMATION FOR THE CONVENIENCE OF THE CONTRACTOR ONLY. THE CONTRACTOR IS RESPONSIBLE TO CONTACT THE OWNER'S REPRESENTATIVE TO REQUEST CLARIFICATION OF DISCREPANCIES BETWEEN THE INFORMATION SHOWN ON THIS PLAN AND INFORMATION SHOWN ELSEWHERE. IN THE EVENT THE CONTRACTOR PROCEEDS WITH CONSTRUCTION WITHOUT OFFICIAL CLARIFICATION FROM THE OWNER'S REPRESENTATIVE, HE SHALL BE LIABLE FOR THE COST OF CORRECTIVE WORK AND SHALL REPAIR OR RECONSTRUCT THE FAULTY WORK TO THE SATISFACTION OF THE OWNER'S REPRESENTATIVE AT NO ADDITIONAL COST TO THE OWNER.
- THE CONTRACTOR IS RESPONSIBLE FOR PROVIDING, ERECTING AND MAINTAINING THE REQUIRED MATERIALS, EQUIPMENT AND MANPOWER NECESSARY FOR PUBLIC SAFETY AND TRAFFIC CONTROL WITHIN THE PROJECT LIMITS AND ON THE APPROACHES TO THE PROJECT. COORDINATE WITH OWNER AS NECESSARY.
- THE CONTRACTOR AGREES THAT IN ACCORDANCE WITH GENERALLY ACCEPTED CONSTRUCTION PRACTICES, CONTRACTOR SHALL BE REQUIRED TO ASSUME SOLE AND COMPLETE RESPONSIBILITY FOR JOB SITE CONDITIONS DURING THE COURSE OF CONSTRUCTION OF THE PROJECT, INCLUDING THE SAFETY OF ALL PERSONS AND PROPERTY, AND THAT THIS REQUIREMENT SHALL BE MADE TO APPLY CONTINUOUSLY AND NOT BE LIMITED TO NORMAL WORKING HOURS. CONTRACTOR FURTHER AGREES TO DEFEND, INDEMNIFY, AND HOLD DESIGN PROFESSIONAL HARMLESS FROM ANY AND ALL LIABILITY, REAL AND ALLEGED, IN CONNECTION WITH THE PERFORMANCE OF WORK ON THIS PROJECT, EXCEPTING LIABILITY ARISING FROM THE SOLE NEGLIGENCE OF THE DESIGN PROFESSIONAL.
- IF ANY ARCHEOLOGICAL, CULTURAL OR HISTORICAL RESOURCES, OR ARTIFACTS OR OTHER FEATURES ARE DISCOVERED DURING THE COURSE OF CONSTRUCTION ANYWHERE ON THE PROJECT SITE, WORK SHALL BE SUSPENDED IN THAT LOCATION UNTIL A QUALIFIED PROFESSIONAL ARCHEOLOGIST ASSESSES THE SIGNIFICANCE OF THE DISCOVERY. THE OWNER SHALL BE NOTIFIED IMMEDIATELY OF ANY FINDS. IN CONSULTATION WITH THE ARCHEOLOGIST AND THE GOVERNING AGENCY, APPROPRIATE MEASURES FOR PRESERVATION SHALL BE ESTABLISHED PRIOR TO THE COMMENCEMENT OF WORK.
- THE LOCATION OF EXISTING UNDERGROUND UTILITIES ON THESE PLANS ARE APPROXIMATE. A REASONABLE EFFORT HAS BEEN MADE TO LOCATE AND DELINEATE ALL UNDERGROUND FACILITIES. HOWEVER RODNEY EVANS + PARTNERS, PLLC, ASSUMES NO LIABILITY FOR THE ACCURACY OR COMPLETENESS OF THE EXISTING FACILITIES SHOWN HERE OR FOR THE EXISTENCE OF OTHER UNDERGROUND UTILITIES OR OBJECTS WHICH MAY BE DISCOVERED BUT ARE NOT SHOWN ON THESE PLANS. THE CONTRACTOR SHALL DETERMINE THE EXACT LOCATION OF ANY EXISTING UTILITIES BEFORE COMMENCING WORK, AND AGREES TO BE FULLY RESPONSIBLE FOR ANY AND ALL DAMAGE DUE TO CONTRACTOR'S FAILURE TO EXACTLY LOCATE AND PRESERVE ANY AND ALL UNDERGROUND UTILITIES.
- IN THE EVENT OF A DISCREPANCY, NOTIFY THE LANDSCAPE ARCHITECT IMMEDIATELY.

NO.	REVISION/ISSUE	DATE
1	Addendum	12/27/22
-	-	-
-	-	-
-	-	-

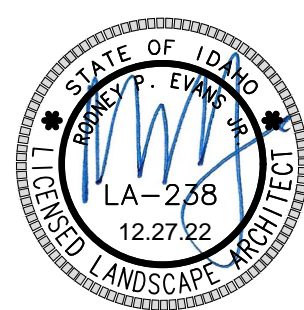

**811**  
Know what's below.  
Call before you dig.  
CALL 2 BUSINESS DAYS  
IN ADVANCE BEFORE  
YOU DIG, GRADE, OR  
EXCAVATE FOR THE  
MARKING OF  
UNDERGROUND  
MEMBER UTILITIES

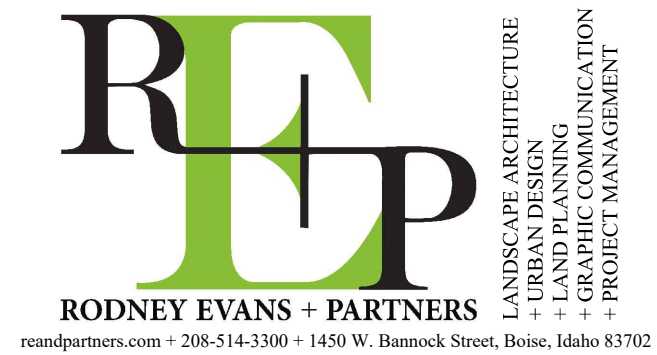

PICKLES BUTTE - CANYON CO. LANDFILL  
15500 MISSOURI AVE.  
NAMPA, IDAHO 83686  
SITE IMPROVEMENTS

## OVERALL PAVING DEMOLITION PLAN

PROJECT	21040	SHEET
DATE	10/13/22	D1.00
DRAWN BY	JR/SM	CHECKED BY
	RE	



Z:\REP Projects\2021\21040 Canyon Co. Landfill\CAD Sheets\21040 Demo Paving02 Addendum.dwg plotted by: Josh on Mon, December 19 2022 at 04:13 PM



# PAVING DEMOLITION PLAN - AREA ONE

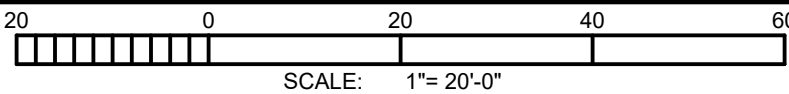

MATCHLINE - SEE SHEET D1.10  
MATCHLINE - SEE SHEET D1.20

## DEMOLITION PLAN LEGEND

- PRESCRIPTIVE 25' RIGHT-OF-WAY (VERIFY)
- ASPHALT SAWCUT LINE

- EXISTING ASPHALT PAVING & HARDSCAPE DEMO AREA, SEE SHEETS D1.10 - D1.30
- EXISTING LANDSCAPE AREA TO BE DEMOLISHED, SEE SHEETS D1.20

## CALLOUT NOTES

# CALLOUT NUMBERS REFER TO NUMBERED NOTES BELOW

1. RETAIN AND PROTECT EXISTING VEHICLE SCALE.
2. RETAIN AND PROTECT EXISTING TURF AREA, REGRADE AND BACKFILL ADJACENT LANDSCAPE AREAS.
3. RETAIN AND PROTECT EXISTING FENCING.
4. REMOVE EXISTING BOLLARD.
5. SAVE AND PROTECT EXISTING GUY WIRE.
6. REMOVE AND RESET TOP OF WATER MANHOLE WITH A NEW CONCRETE COLLAR AT FINISH GRADE OF NEW ASPHALT.
7. REMOVE ALL EXISTING LANDSCAPE IMPROVEMENTS IN THIS AREA. RE-GRADE AS NECESSARY FOR ASPHALT EXPANSION.
8. RETAIN AND PROTECT EXISTING CULVERT.
9. REMOVE AND RETAIN RAILROAD TIES, COORDINATE WITH OWNER FOR ON-SITE STORAGE.
10. RESET RAILROAD TIES AFTER CURBING AND PAVING WORK IS COMPLETE.
11. SUBGRADE/BASE BY OTHERS.
12. RETAIN AND REUSE EXISTING KNOX BOX.
13. RETAIN AND PROTECT EXISTING SIGNAGE ON GATE, COORDINATE WITH OWNER FOR STORAGE.
14. RETAIN AND PROTECT EXISTING CONCRETE STAIRS, LANDINGS, AND HANDRAILS.
15. RETAIN AND PROTECT EXISTING LIGHT POLE.
16. RETAIN AND PROTECT EXISTING SIGNAGE.
17. SAVE AND PROTECT EXISTING BOLLARD.

NO.	REVISION/ISSUE	DATE
1	Addendum	12/27/22
-	-	-
-	-	-
-	-	-



**811**  
Know what's below.  
Call before you dig.  
CALL 2 BUSINESS DAYS  
IN ADVANCE BEFORE  
YOU DIG, GRADE, OR  
EXCAVATE FOR THE  
MARKING OF  
UNDERGROUND  
MEMBER UTILITIES



RODNEY EVANS + PARTNERS  
roedpartners.com • 208-514-3300 • 1450 W. Bascom Street, Boise, Idaho 83702

PICKLES BUTTE - CANYON CO. LANDFILL  
15500 MISSOURI AVE.  
NAMPA, IDAHO 83686  
SITE IMPROVEMENTS

## PAVING DEMOLITION PLAN - AREA ONE

PROJECT	21040	SHEET  <b>D1.10</b>
DATE	10/13/22	
DRAWN BY	JR/SM	
CHECKED BY	RE	



Z:\REP Projects\2021\21040 Canyon Co. Landfill\CAD Sheets\21040 Demo Paving02 Addendum.dwg plotted by: Josh on Mon, December 19, 2022 at 04:14 PM

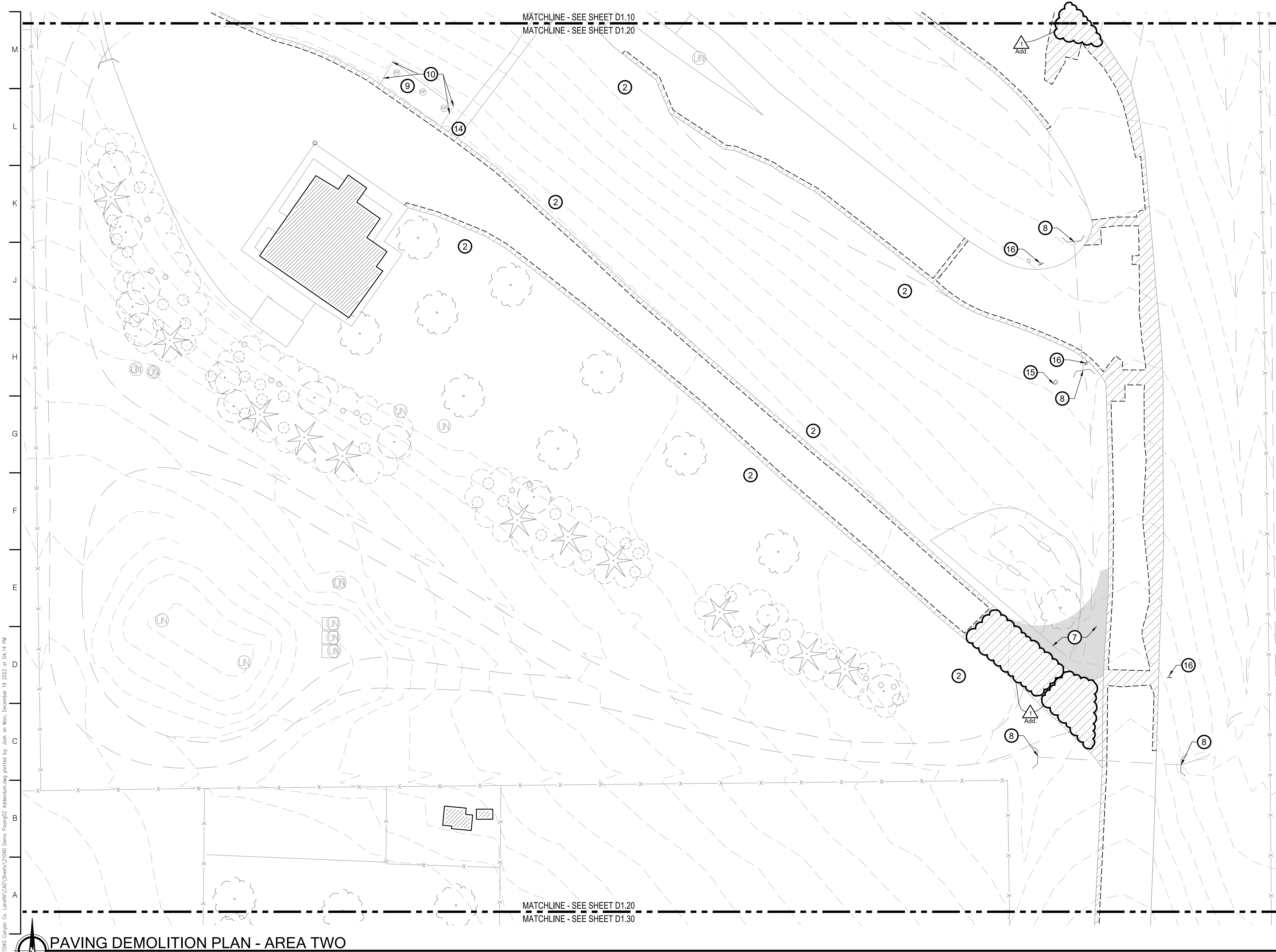

DEMOLITION PLAN LEGEND

--- PRESCRIPTIVE 25' RIGHT-OF-WAY (VERIFY)  
--- ASPHALT SAWCUT LINE

EXISTING ASPHALT PAVING & HARDSCAPE DEMO AREA, SEE SHEETS D1.10 - D1.30  
EXISTING LANDSCAPE AREA TO BE DEMOLISHED, SEE SHEETS D1.20

CALLOUT NOTES

1. RETAIN AND PROTECT EXISTING VEHICLE SCALE.
2. RETAIN AND PROTECT EXISTING TURF AREA, REGRADE AND BACKFILL ADJACENT LANDSCAPE AREAS.
3. RETAIN AND PROTECT EXISTING FENCING.
4. REMOVE EXISTING BOLLARD.
5. SAVE AND PROTECT EXISTING GUY WIRE.
6. REMOVE AND RESET TOP OF WATER MANHOLE WITH A NEW CONCRETE COLLAR AT FINISH GRADE OF NEW ASPHALT.
7. REMOVE ALL EXISTING LANDSCAPE IMPROVEMENTS IN THIS AREA. RE-GRADE AS NECESSARY FOR ASPHALT EXPANSION.
8. RETAIN AND PROTECT EXISTING CULVERT.
9. REMOVE AND RETAIN RAILROAD TIES, COORDINATE WITH OWNER FOR ON-SITE STORAGE.
10. RESET RAILROAD TIES AFTER CURBING AND PAVING WORK IS COMPLETE.
11. SUBGRADE/BASE BY OTHERS.
12. RETAIN AND REUSE EXISTING KNOX BOX.
13. RETAIN AND PROTECT EXISTING SIGNAGE ON GATE, COORDINATE WITH OWNER FOR STORAGE.
14. RETAIN AND PROTECT EXISTING CONCRETE STAIRS, LANDINGS, AND HANDRAILS.
15. RETAIN AND PROTECT EXISTING LIGHT POLE.
16. RETAIN AND PROTECT EXISTING SIGNAGE.
17. SAVE AND PROTECT EXISTING BOLLARD.

1	Addendum	12/27/22
-	-	-
-	-	-
-	-	-
NO.	REVISION/ISSUE	DATE

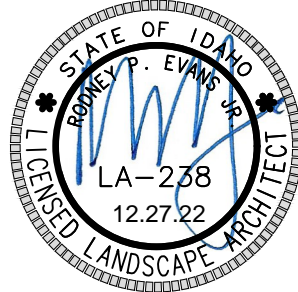

**811**  
Know what's below.  
Call before you dig.  
CALL 2 BUSINESS DAYS  
IN ADVANCE BEFORE  
YOU DIG, GRADE, OR  
EXCAVATE FOR THE  
MARKING OF  
UNDERGROUND  
MEMBER UTILITIES

**RELP**  
RODNEY EVANS + PARTNERS  
LANDSCAPE ARCHITECTURE  
+ LAND PLANNING  
+ URBAN DESIGN  
+ PROJECT MANAGEMENT

PICKLES BUTTE - CANYON CO. LANDFILL  
15500 MISSOURI AVE.  
NAMPA, IDAHO 83686  
SITE IMPROVEMENTS

PAVING DEMOLITION PLAN - AREA TWO

PROJECT	21040	SHEET	D1.20
DATE	10/13/22		
DRAWN BY	JR/SM	CHECKED BY	
		RE	



Z:\REP Projects\2021\21040 Canyon Co. Landfill\CAD Sheets\21040 Demo Paving02 Addendum.dwg plotted by: Josh on Mon, December 19, 2022 at 04:14 PM

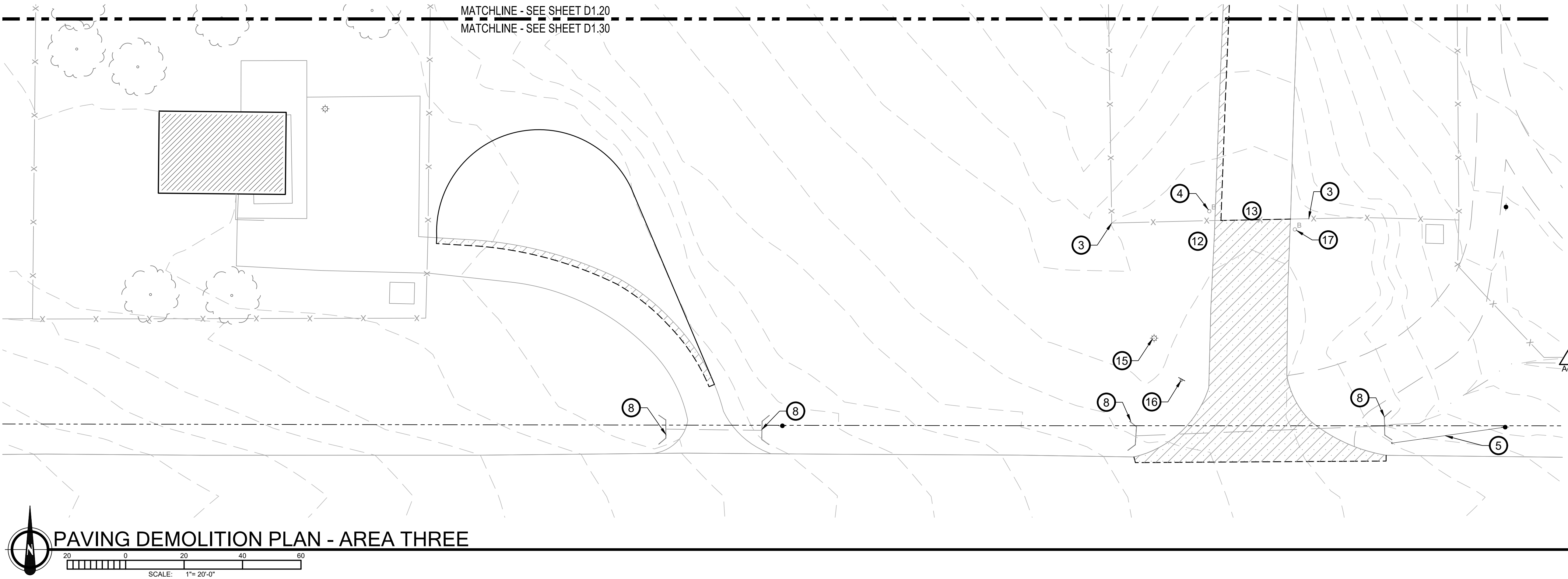

#### DEMOLITION PLAN LEGEND

----- PRESCRIPTIVE 25' RIGHT-OF-WAY (VERIFY)  
----- ASPHALT SAWCUT LINE

EXISTING ASPHALT PAVING & HARDSCAPE DEMO AREA, SEE SHEETS D1.10 - D1.30  
 EXISTING LANDSCAPE AREA TO BE DEMOLISHED, SEE SHEETS D1.20

#### CALLOUT NOTES

- # CALLOUT NUMBERS REFER TO NUMBERED NOTES BELOW
1. RETAIN AND PROTECT EXISTING VEHICLE SCALE.
  2. RETAIN AND PROTECT EXISTING TURF AREA, REGRADE AND BACKFILL ADJACENT LANDSCAPE AREAS.
  3. RETAIN AND PROTECT EXISTING FENCING.
  4. REMOVE EXISTING BOLLARD.
  5. SAVE AND PROTECT EXISTING GUY WIRE.
  6. REMOVE AND RESET TOP OF WATER MANHOLE WITH A NEW CONCRETE COLLAR AT FINISH GRADE OF NEW ASPHALT.
  7. REMOVE ALL EXISTING LANDSCAPE IMPROVEMENTS IN THIS AREA. RE-GRADE AS NECESSARY FOR ASPHALT EXPANSION.
  8. RETAIN AND PROTECT EXISTING CULVERT.
  9. REMOVE AND RETAIN RAILROAD TIES, COORDINATE WITH OWNER FOR ON-SITE STORAGE.
  10. RESET RAILROAD TIES AFTER CURBING AND PAVING WORK IS COMPLETE.
  11. SUBGRADE/BASE BY OTHERS.
  12. RETAIN AND REUSE EXISTING KNOX BOX.
  13. RETAIN AND PROTECT EXISTING SIGNAGE ON GATE, COORDINATE WITH OWNER FOR STORAGE.
  14. RETAIN AND PROTECT EXISTING CONCRETE STAIRS, LANDINGS, AND HANDRAILS.
  15. RETAIN AND PROTECT EXISTING LIGHT POLE.
  16. RETAIN AND PROTECT EXISTING SIGNAGE.
  17. SAVE AND PROTECT EXISTING BOLLARD.

Add.	1	Addendum	12/27/22
	-	-	-
	-	-	-
	-	-	-
NO. REVISION/ISSUE			DATE



**811**  
Know what's below.  
Call before you dig.  
CALL 2 BUSINESS DAYS  
IN ADVANCE BEFORE  
YOU DIG, GRADE, OR  
EXCAVATE FOR THE  
MARKING OF  
UNDERGROUND  
MEMBER UTILITIES

**REP**  
RODNEY EVANS + PARTNERS

LANDSCAPE ARCHITECTURE  
+ LAND PLANNING  
+ LANDSCAPE MANAGEMENT  
+ PROJECT MANAGEMENT

rodpartners.com • 208-514-3300 • 1450 W. Bascom Street, Boise, Idaho 83702

PICKLES BUTTE - CANYON CO. LANDFILL  
15500 MISSOURI AVE.  
NAMPA, IDAHO 83686  
SITE IMPROVEMENTS

#### PAVING DEMOLITION PLAN - AREA THREE

PROJECT	21040	SHEET
DATE	10/13/22	D1.30
DRAWN BY	JR/SM	
CHECKED BY	RE	

BID SET



Z:\REP Projects\2021\21040 Canyon Co. Landfill\CAD\Sheets\21040\_CD\_Landscape05 Addendum.dwg plotted by: Josh on Mon, December 19, 2022 at 04:11 PM

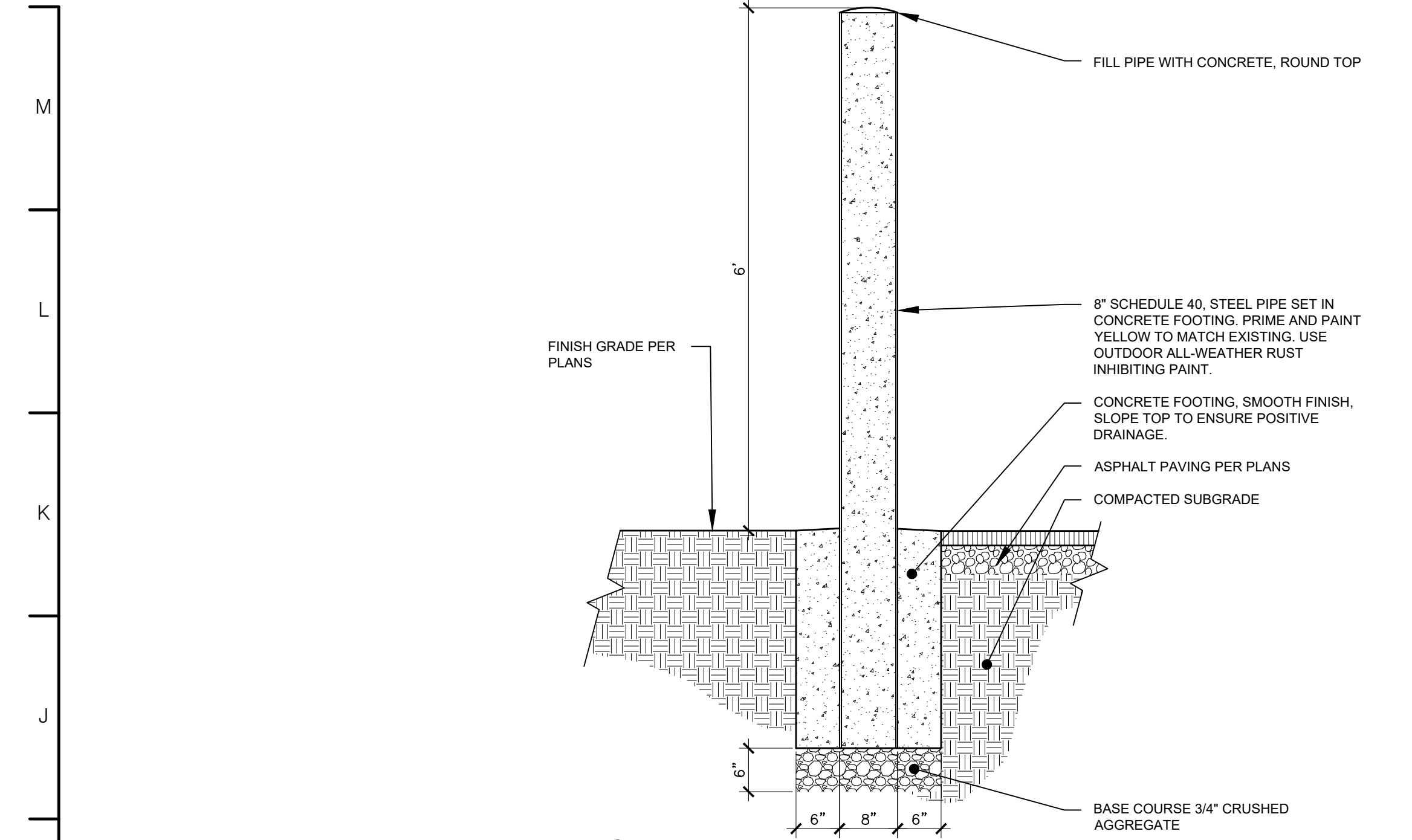

## 1 STEEL BOLLARD

3/4" = 1'-0"

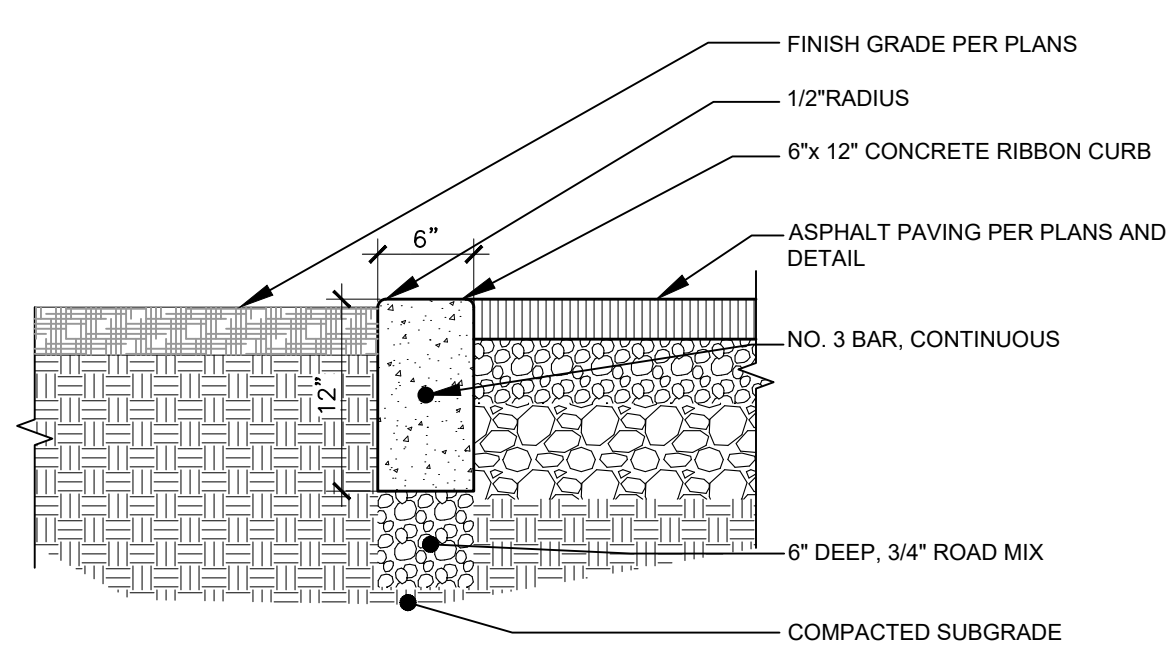

## 2 CONCRETE RIBBON CURB

1" = 1'-0"

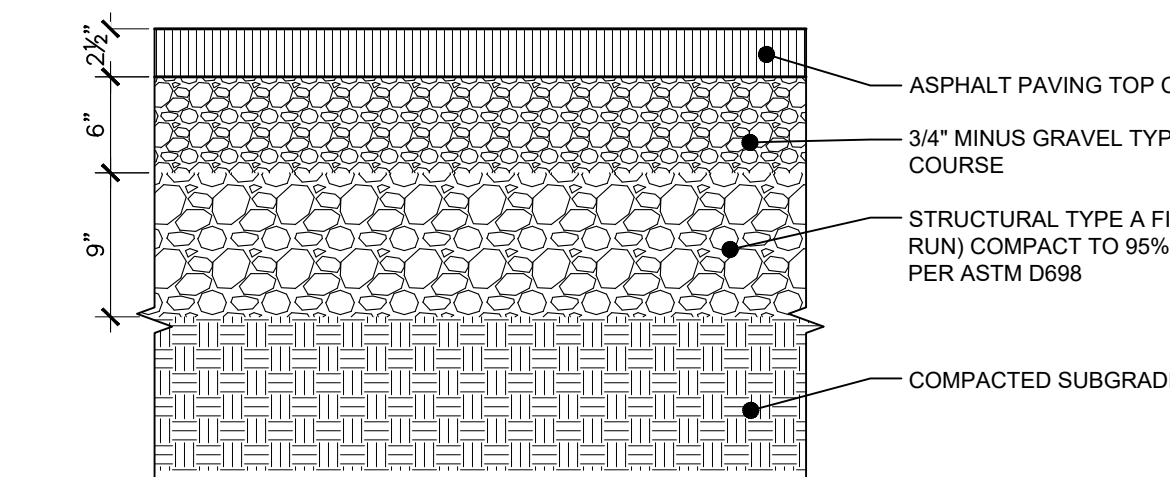

## 3 ASPHALT PAVING

1" = 1'-0"

### CALLOUT NOTES

1. SAVE AND PROTECT EXISTING LANDSCAPE.
2. SAVE AND PROTECT EXISTING TURF AREA.
3. NEW ASPHALT PAVING, SEE DETAIL 3/S1.10.
4. NEW CONCRETE RIBBON CURB, SEE DETAIL 2/S1.10.
5. EXISTING ROLLING GATE SHALL BE MODIFIED PER PROPOSED ROADWAY EDGE PER WIDENING OF ROADWAY. CONTRACTOR SHALL PROVIDE NEW CHAINLINK GATE AND ALL OTHER ACCESSORIES NEEDED TO REPLACE GATE, MATCH EXISTING MANUFACTURER AND FEATURES OF EXISTING ROLLING CHAINLINK GATE. ASPHALT REPAIR LOCATION, FIELD VERIFY EXTENTS OF BROKEN ASPHALT. CUT AND REMOVE DAMAGED ASPHALT AND REPAIR PER DETAIL 3/S1.10.
6. INSTALL NEW BOLLARD, SEE DETAIL 1/S1.10.
7. REPAIR EXISTING CULVERT OPENING TO ENSURE FULL OPENING PER EXISTING CULVERT SIZE. RE-GRADE SWALE TO ENSURE POSITIVE DRAINAGE AND REMOVE BUILT UP SILT.
8. EXTEND EXISTING CULVERT. MATCH EXISTING OR APPROVED EQUAL.
9. CONSTRUCT APPROACH PER STANDARD DRAWING NO. ACCHD-106.
10. RELOCATE EXISTING SIGN TO THIS LOCATION.
11. REMOVE EXISTING LANDSCAPE IMPROVEMENTS IN THIS LOCATION. STOCKPILE BOULDERS IN ADJACENT LANDSCAPE AREA FOR FUTURE PHASE USE.
12. IRRIGATION SLEEVE LOCATION. CONTRACTOR SHALL CUT 2'-0" WIDE STRIP IN ASPHALT, PLACE 6" DIAMETER SCH. 40 PVC PIPE SLEEVE AT DEPTH OF 18", BACKFILL AND ASPHALT PATCH PER ASPHALT DETAIL. PIPE SLEEVE SHALL EXTEND 2'-0" PAST RIBBON CURB/EDGE OF ASPHALT. LABEL AND PLACE 2"X1'X36" LONG WOODEN STAKE AT ENDS OF PIPE SLEEVE LOCATIONS FOR FUTURE USE. DRIVE STAKE 18" MIN. INTO ADJACENT GROUND.
13. EXISTING EDGE OF ASPHALT.
14. MONUMENT SIGN BY OWNER.
15. CONCRETE WHEELSTOP, SEE DETAIL 1/S1.20.
16. SAVE AND PROTECT POWER POLE GUY WIRE, SEE DEMO PLANS.
17. SAVE AND PROTECT EXISTING BOLLARD.
18. FOG LINE STRIPING.

### PAVING LEGEND

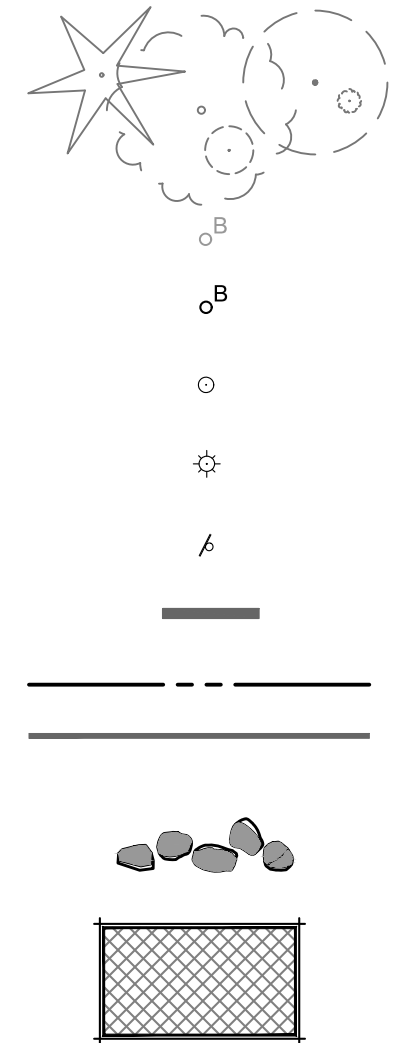

### PAINTED STRIPING

ALL PAINT TO BE 100% ACRYLIC MARKING PAINT, MEETING FEDERAL SPECIFICATIONS TTP 1952 TYPES 1 AND 2. ALL SURFACES SCHEDULED TO RECEIVE PAINT FINISH: REMOVE DIRT, LOOSE MORTAR, SCALE, SALT OR ALKALI POWDER AND OTHER FOREIGN MATTER. REMOVE OIL AND GREASE WITH A SOLUTION OF TRI-SODIUM PHOSPHATE. RINSE WELL AND ALLOW TO DRY. REMOVE STAINS CAUSED BY WEATHERING OF CORRODING METALS WITH A SOLUTION OF SODIUM METASILICATE AFTER THOROUGHLY WETTING WITH WATER. ALLOW TO DRY.

NO.	REVISION/ISSUE	DATE
1	Addendum	12/27/22
-	-	-
-	-	-
-	-	-

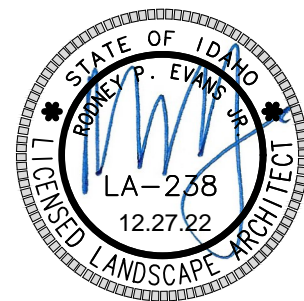

PICKLES BUTTE - CANYON CO. LANDFILL  
15500 MISSOURI AVE.  
NAMPA, IDAHO 83686  
SITE IMPROVEMENTS

PAVING PLAN - AREA ONE

PROJECT	21040	SHEET
DATE	10/13/22	S1.10
DRAWN BY	JR	CHECKED BY
	RE	

BID SET



Z:\REP Projects\2021\21040 Canyon Co. Landfill\CAD\Sheets\21040\_CD\_Landscape05 Addendum.dwg plotted by: Josh on Mon, December 19, 2022 at 04:12 PM

M  
L  
K  
J  
H  
G  
F  
E  
D  
C  
B  
A

### CALLOUT NOTES

# CALLOUT NUMBERS  
REFER TO NUMBERED  
NOTES BELOW

1. SAVE AND PROTECT EXISTING LANDSCAPE.
2. SAVE AND PROTECT EXISTING TURF AREA.
3. NEW ASPHALT PAVING, SEE DETAIL 3/S1.10.
4. NEW CONCRETE RIBBON CURB, SEE DETAIL 2/S1.10.
5. EXISTING ROLLING GATE SHALL BE MODIFIED PER PROPOSED ROADWAY EDGE PER WIDENING OF ROADWAY. CONTRACTOR SHALL PROVIDE NEW CHAINLINK GATE AND ALL OTHER ACCESSORIES NEEDED TO REPLACE GATE, MATCH EXISTING MANUFACTURER AND FEATURES OF EXISTING ROLLING CHAINLINK GATE.
6. ASPHALT REPAIR LOCATION, FIELD VERIFY EXTENTS OF BROKEN ASPHALT. CUT AND REMOVE DAMAGED ASPHALT AND REPAIR PER DETAIL 3/S1.10.
7. INSTALL NEW BOLLARD, SEE DETAIL 1/S1.10.
8. REPAIR EXISTING CULVERT OPENING TO ENSURE FULL OPENING PER EXISTING CULVERT SIZE. RE-GRADE SWALE TO ENSURE POSITIVE DRAINAGE AND REMOVE BUILT UP SILT.
9. EXTEND EXISTING CULVERT. MATCH EXISTING OR APPROVED EQUAL.
10. CONSTRUCT APPROACH PER STANDARD DRAWING NO. ACCHD-106.
11. RELOCATE EXISTING SIGN TO THIS LOCATION.
12. REMOVE EXISTING LANDSCAPE IMPROVEMENTS IN THIS LOCATION. STOCKPILE BOULDERS IN ADJACENT LANDSCAPE AREA FOR FUTURE PHASE USE.
13. IRRIGATION SLEEVE LOCATION. CONTRACTOR SHALL CUT 2'-0" WIDE STRIP IN ASPHALT, PLACE 6" DIAMETER SCH. 40 PVC PIPE SLEEVE AT DEPTH OF 18", BACKFILL AND ASPHALT PATCH PER ASPHALT DETAIL. PIPE SLEEVE SHALL EXTEND 2'-0" PAST RIBBON CURBEDGE OF ASPHALT. LABEL AND PLACE 2"X1'X36" LONG WOODEN STAKE AT ENDS OF PIPE SLEEVE LOCATIONS FOR FUTURE USE. DRIVE STAKE 18" MIN. INTO ADJACENT GROUND.
14. EXISTING EDGE OF ASPHALT.
15. MONUMENT SIGN BY OWNER.
16. CONCRETE WHEEL STOP, SEE DETAIL 1/S1.20.
17. SAVE AND PROTECT POWER POLE GUY WIRE, SEE DEMO PLANS.
18. SAVE AND PROTECT EXISTING BOLLARD.
19. FOG LINE STRIPING.

### PAINTED STRIPING

ALL PAINT TO BE 100% ACRYLIC MARKING PAINT, MEETING FEDERAL SPECIFICATIONS TYP 1 AND 2. ALL TYPES 1 AND 2. ALL SURFACES SCHEDULED TO RECEIVE PAINT FINISH: REMOVE DIRT, LOOSE MORTAR, SCALE, SALT OR ALKALI POWDER AND OTHER FOREIGN MATTER. REMOVE OIL AND GREASE WITH A SOLUTION OF TRI-SODIUM PHOSPHATE, RINSE WELL AND ALLOW TO DRY. REMOVE STAINS CAUSED BY WEATHERING OF CORRODING METALS WITH A SOLUTION OF SODIUM METASILICATE AFTER THOROUGHLY WETTING WITH WATER. ALLOW TO DRY.

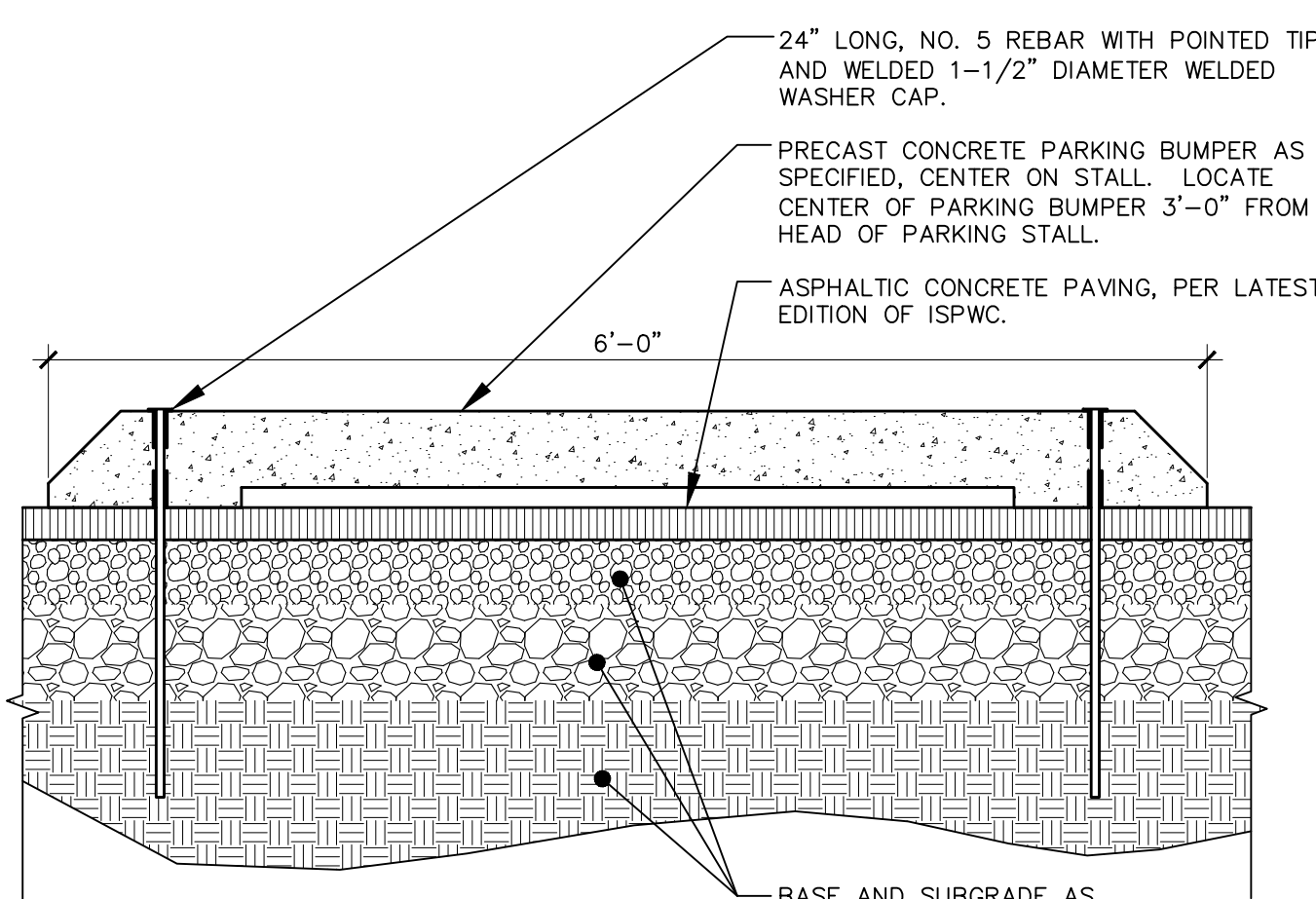

1 CONCRETE PARKING BUMPER

Scale: 1" = 1'-0"

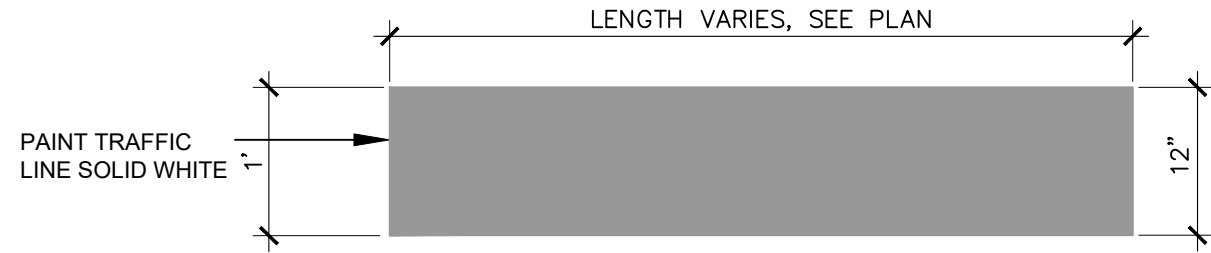

2 STOP BAR

Scale: 3/4" = 1'-0"

### NOTE:

1. VERIFY LOCATION PRIOR TO INSTALLATION.
2. VERIFY LENGTH PRIOR TO INSTALLATION.
3. SEE SPECIFICATIONS FOR ADDITIONAL INFORMATION.

### PAVING PLAN - AREA TWO

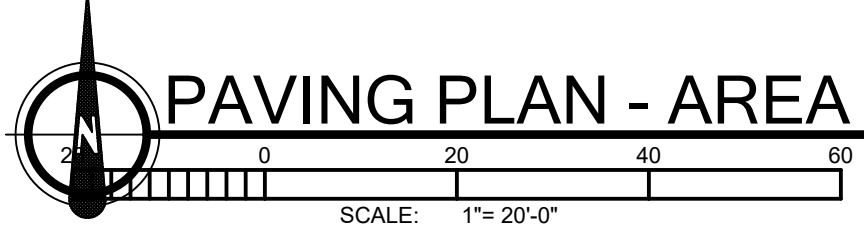

### PAVING LEGEND

- EXISTING PLANTS TO REMAIN
- EXISTING BOLLARD TO BE REMOVED
- NEW BOLLARD LOCATION, SEE DETAIL 1/S1.10
- EXISTING ARM GATE, SAVE AND PROTECT
- EXISTING LIGHT POLE, SAVE AND PROTECT UNLESS NOTED OTHERWISE
- EXISTING SIGN, SAVE AND PROTECT UNLESS NOTED OTHERWISE
- PROPOSED INTERSECTION STOP BAR STRIPING, SEE DETAIL 2/S1.20
- PROPERTY LINE (VERIFY)
- 6" WIDE FOG LINE STRIPING, SEE STRIPING DETAIL
- LANDSCAPE BOULDERS SHOWN FOR REFERENCE ONLY. INSTALLED BY LANDSCAPE CONTRACTOR.
- PROPOSED REPAIR ASPHALT PAVING, SEE DETAIL 3/S1.10. FIELD VERIFY LOCATIONS OF CRACKED ASPHALT.

NO.	REVISION/ISSUE	DATE
1	Addendum	12/27/22
-	-	-
-	-	-
-	-	-

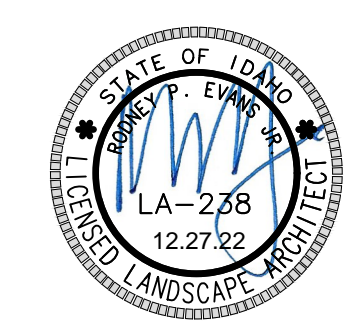

**811**  
Know what's below.  
Call before you dig.  
CALL 2 BUSINESS DAYS  
IN ADVANCE BEFORE  
YOU DIG, GRADE, OR  
EXCAVATE FOR THE  
MARKING OF  
UNDERGROUND  
MEMBER UTILITIES



rodneypartners.com • 208-514-3300 • 1450 W. Bismock Street, Boise, Idaho 83702

PICKLES BUTTE - CANYON CO. LANDFILL  
15500 MISSOURI AVE.  
NAMPA, IDAHO 83686  
SITE IMPROVEMENTS

### PAVING PLAN - AREA TWO

PROJECT		SHEET	S1.20
21040			
DATE			
10/13/22			
DRAWN BY	CHECKED BY		
JR	RE		



Z:\\_REP Projects\2021\21040 Canyon Co. Landfill\CAD Sheets\21040\_CD\_Landscape5 Addendum.dwg plotted by Josh on Mon, December 19, 2022 at 04:12 PM

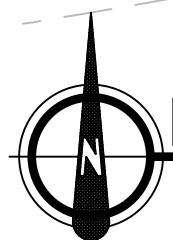

PAVING PLAN - AREA THREE

MISSOURI AVE.

CALLOUT NOTES

1. SAVE AND PROTECT EXISTING LANDSCAPE.
2. SAVE AND PROTECT EXISTING TURF AREA.
3. NEW ASPHALT PAVING, SEE DETAIL 3/S1.10.
4. NEW CONCRETE RIBBON CURB, SEE DETAIL 2/S1.10.
5. EXISTING ROLLING GATE SHALL BE MODIFIED PER PROPOSED ROADWAY EDGE PER WIDENING OF ROADWAY. CONTRACTOR SHALL PROVIDE NEW CHAINLINK GATE AND ALL OTHER ACCESSORIES NEEDED TO REPLACE GATE. MATCH EXISTING MANUFACTURER AND FEATURES OF EXISTING ROLLING CHAINLINK GATE.
6. ASPHALT REPAIR LOCATION, FIELD VERIFY EXTENTS OF BROKEN ASPHALT. CUT AND REMOVE DAMAGED ASPHALT AND REPAIR PER DETAIL 3/S1.10.
7. INSTALL NEW BOLLARD, SEE DETAIL 1/S1.10.
8. REPAIR EXISTING CULVERT OPENING TO ENSURE FULL OPENING PER EXISTING CULVERT SIZE. RE-GRADE SWALE TO ENSURE POSITIVE DRAINAGE AND REMOVE BUILT UP SILT.
9. EXTEND EXISTING CULVERT. MATCH EXISTING OR APPROVED EQUAL.
10. CONSTRUCT APPROACH PER STANDARD DRAWING NO. ACCHD-106.
11. RELOCATE EXISTING SIGN TO THIS LOCATION.
12. REMOVE EXISTING LANDSCAPE IMPROVEMENTS IN THIS LOCATION. STOCKPILE BOULDERS IN ADJACENT LANDSCAPE AREA FOR FUTURE PHASE USE.
13. IRRIGATION SLEEVE LOCATION, CONTRACTOR SHALL CUT 2'-0" WIDE STRIP IN ASPHALT, PLACE 6" DIAMETER SCH. 40 PVC PIPE SLEEVE AT DEPTH OF 18", BACKFILL AND ASPHALT PATCH PER ASPHALT DETAIL. PIPE SLEEVE SHALL EXTEND 2'-0" PAST RIBBON CURB/EDGE OF ASPHALT. LABEL AND PLACE 2"x1"x36" LONG WOODEN STAKE AT ENDS OF PIPE SLEEVE LOCATIONS FOR FUTURE USE. DRIVE STAKE 18" MIN. INTO ADJACENT GROUND.
14. EXISTING EDGE OF ASPHALT.
15. MONUMENT SIGN BY OWNER.
16. CONCRETE WHEELSTOP, SEE DETAIL 1/S1.20.
17. SAVE AND PROTECT POWER POLE GUY WIRE, SEE DEMO PLANS.
18. SAVE AND PROTECT EXISTING BOLLARD.
19. FOG LINE STRIPING

PAVING LEGEND

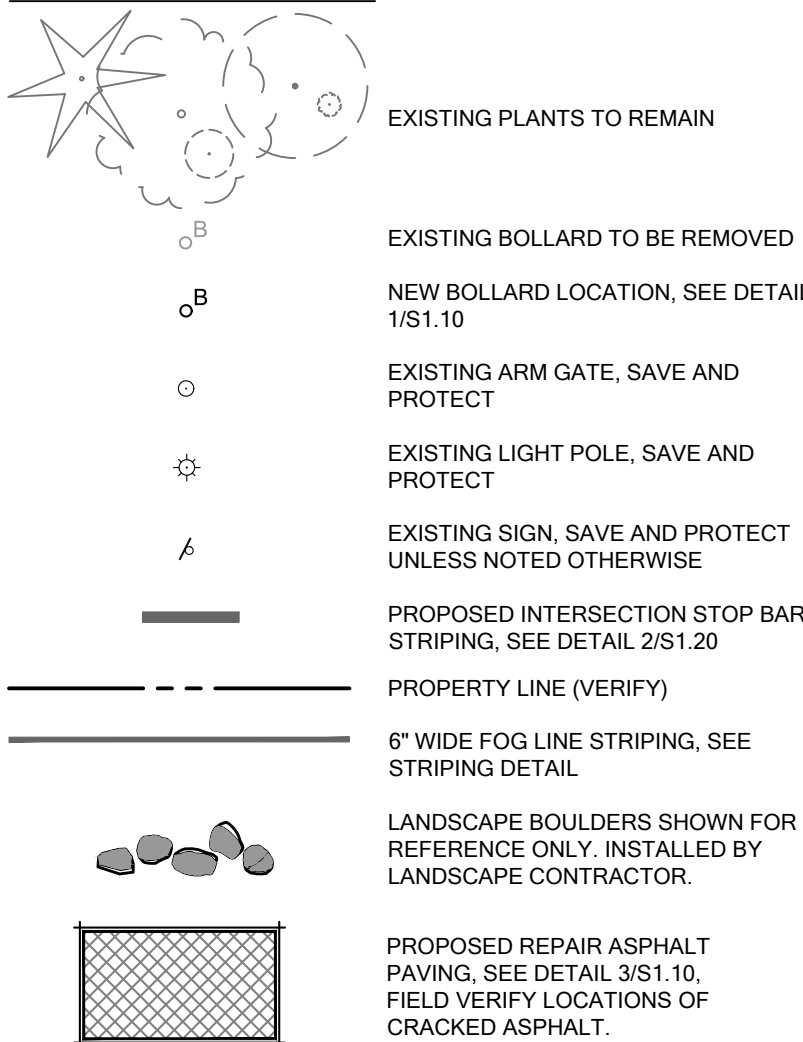

PAINTED STRIPING

ALL PAINT TO BE 100% ACRYLIC MARKING PAINT, MEETING FEDERAL SPECIFICATIONS TYP 1952 TYPES 1 AND 2. ALL SURFACES SCHEDULED TO RECEIVE PAINT FINISH: REMOVE DIRT, LOOSE MORTAR, SCALE, SALT OR ALKALI POWDER AND OTHER FOREIGN MATTER. REMOVE OIL AND GREASE WITH A SOLUTION OF TRI-SODIUM PHOSPHATE. RINSE WELL AND ALLOW TO DRY. REMOVE STAINS CAUSED BY WEATHERING OF CORRODING METALS WITH A SOLUTION OF SODIUM METASILICATE AFTER THOROUGHLY WETTING WITH WATER. ALLOW TO DRY.

MATCHLINE - SEE SHEET S1.20  
MATCHLINE - SEE SHEET S1.30

1	Addendum	12/27/22
-	-	-
-	-	-
-	-	-
NO.	REVISION/ISSUE	DATE

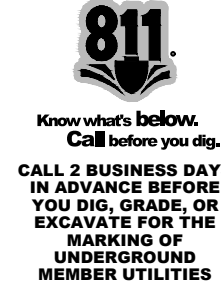
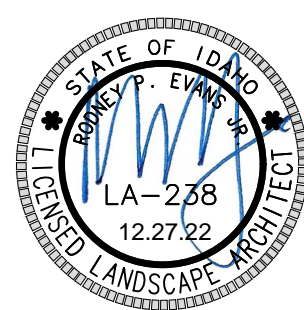

RODNEY EVANS + PARTNERS  
rodneyevans.com • 208-514-3300 • 1450 W. Bamcock Street, Boise, Idaho 83702

LANDSCAPE ARCHITECTURE  
+ URBAN DESIGN  
+ LAND PLANNING  
+ PROJECT MANAGEMENT

PICKLES BUTTE - CANYON CO. LANDFILL  
15500 MISSOURI AVE.  
NAMPA, IDAHO 83686  
SITE IMPROVEMENTS

PAVING PLAN - AREA THREE

PROJECT	21040	SHEET	S1.30
DATE	10/13/22		
DRAWN BY	JR	CHECKED BY	RE